

# CUS - CENTRIFUGAL UTILITY SET

## Fan Dimensions

### Belt-Drive

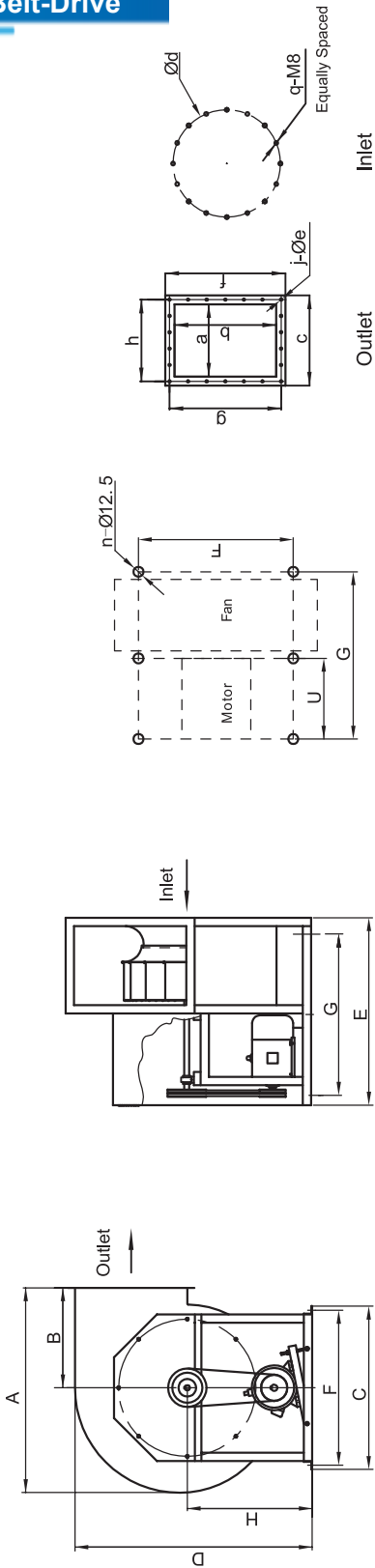

Base Bolts Arrangement

Model	A	B	C	D	E	F	G	H	K	L	M	P	Q	R	S	T	U	a	b	c	d	e	f	g	h	j	n	q	Weight (Kg)
CUS-300	528	250	490	688	625	440	500	380	608	650	398	587	536	630	507	778	0	215	305	295	350	9	385	3x115	3x85	12	4	8	49
CUS-425	730	335	650	938	740	600	575	510	830	900	540	812	748	845	718	1050	0	300	428	380	495	9	505	4x117.5	3x115	14	4	8	76
CUS-500	850	410	730	1028	845	690	710	550	920	1035	628	898	848	960	815	1178	355	335	475	425	570	11	565	5x105	3x128.5	16	6	8	98
CUS-575	965	460	800	1158	900	750	725	615	1040	1168	708	1015	968	1075	930	1323	363	380	540	480	645	11	640	5x119	3x145	16	6	8	150
CUS-675	1102	525	910	1308	1010	860	825	690	1185	1344	808	1155	1113	1215	1070	1498	413	430	615	530	750	11	715	5x134	4x121.5	18	6	16	215
CUS750	1235	600	980	1430	1135	930	950	750	1296	1490	905	1266	1225	1350	1182	1655	475	475	675	575	825	11	775	5x145	5x105	20	6	16	315
CUS-900	1435	700	1130	1628	1208	1080	1000	850	1498	1737	1046	1468	1426	1550	1384	1896	500	545	775	645	975	11	875	6x137.5	5x119	22	6	16	440
CUS1000	1573	765	1230	1780	1368	1180	1125	925	1640	1905	1145	1608	1570	1690	1525	2070	563	595	850	695	1075	11	950	6x150	5x129	22	6	16	550

Note ● The motor weight is not included in the above table.

# CUS - CENTRIFUGAL UTILITY SET

**Direct-Drive**

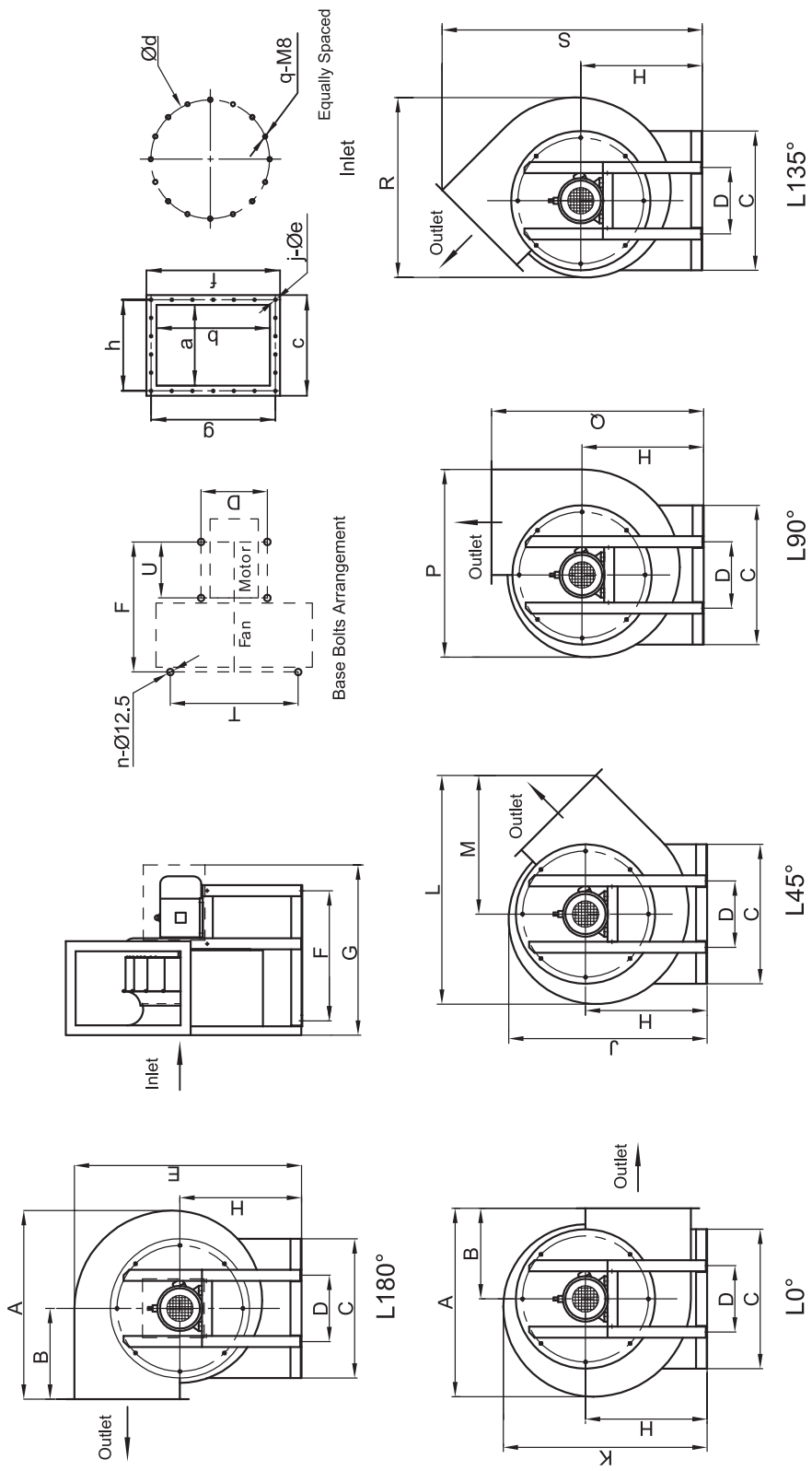

Model	A	B	C	D			E	F			G	H	J	K	L	M	P	Q	R	S	T	U		Kg										
				2P	4P	6P		8P	6P	8P																								
CUS-300D	528	250	490	280	230	230	688	390	390	390	550	380	587	608	650	398	536	630	507	778	340	215	305	295	350	9	385	3x115	3x85	12	4	8	46	
CUS-425D	730	335	650	270	250	250	938	460	460	460	650	510	812	830	900	540	748	845	718	1050	500	300	428	380	495	9	505	4x117.5	3x115	14	4	8	72	
CUS-500D	850	410	730	300	270	250	1028	580	500	500	750	550	898	920	1035	628	848	960	815	1178	580	335	475	425	570	11	565	5x105	3x128.5	16	6	8	93	
CUS-575D	965	460	800	300	270	1158	1158	570	570	570	800	615	1015	1040	1168	708	968	1075	930	1323	650	380	540	480	645	11	640	5x119	3x145	16	6	8	140	
CUS-675D	1102	525	910	380	380	1308	1308	730	680	920	690	1155	1185	1344	808	1113	1215	1070	1498	750	270	220	430	615	530	750	11	715	5x134	4x121.5	18	6	16	205
CUS-750D	1235	600	980	420	420	1430	1430	800	760	1000	750	1266	1296	1490	905	1225	1350	1182	1655	800	300	260	475	675	575	825	11	775	5x145	5x105	20	6	16	300
CUS-900D	1435	700	1130	490	490	1628	1628	950	1150	850	1468	1498	1737	1046	1426	1550	1384	1896	975	370	545	775	645	975	11	875	6x137.5	5x119	22	6	16	418		
CUS-1000D	1573	765	1230	520	520	1780	1780	1075	1300	925	1608	1640	1905	1145	1570	1690	1525	2070	1075	450	595	850	695	1075	11	950	6x150	5x129	22	6	16	525		

Note • The motor weight is not included in the above table.